



MASTER-TROL PLUS PACKAGE

RETROFIT APPLICATION:

TOILET UNIT w/ PNEUMATIC PUSHBUTTON



Qty: 4

EZ-MTP PRE-PROGRAMMED SETTINGS

WHEN FLUSHED 2 TIMES WITHIN A 5-MINUTE PERIOD, THE FLUSH VALVE WILL BE LOCKED OUT AND WILL BE UNABLE TO FLUSH FOR 15 MINUTES.

ORDER SKU: EZ-MTP-WC-4

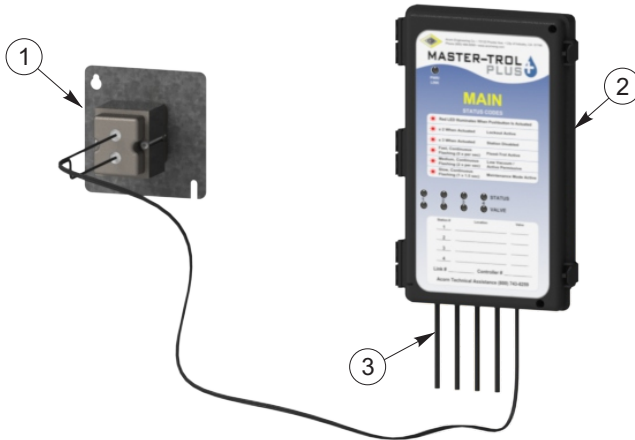

Quantity: 1

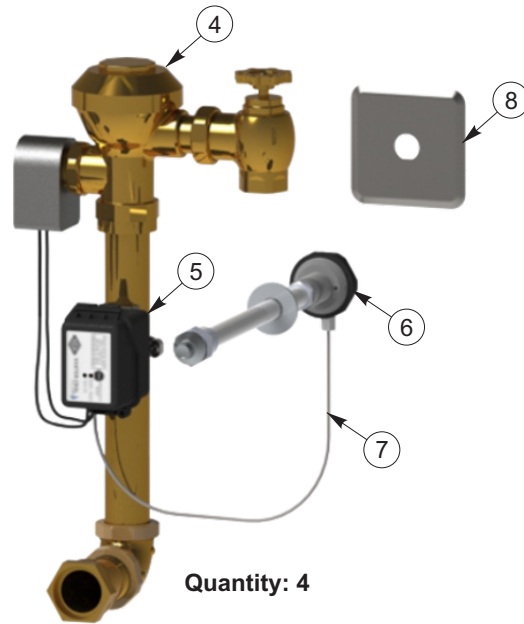

Quantity: 4

| ITEM # | COMPONENTS PROVIDED |
|--------|--|
| 1 | 24VAC, 50 VA Transformer with 4" X 4" Mtg. Plate |
| 2 | MTP Main Controller |
| 3 | MTP Station Cable (CaT 5e) 15' |
| 4 | Electronic Solenoid Operated Flush Valve, 1.28 GPF |

| ITEM # | COMPONENTS PROVIDED |
|--------|--|
| 5 | -MTPFV Flush Valve Branch Box Assembly |
| 6 | 8" Single Temp. Actuated Air-Trol Pushbutton Assembly |
| 7 | 1/8" Clear Tubing for Pneumatic Flush Valve Activation |
| 8 | Anti-Rotational Pushbutton Mounting Plate |

Please visit www.acorneng.com for most current specifications.

